

Introducing the new tooth system

**Increased safety features.
Increased productivity.
Increased reliability.**



Tooth systems are often viewed as interchangeable from one manufacturer to another.

This is not the case with Kprime by Hensley. We have built a truly unique product

that is stronger and longer lasting with additional safety-enhancing features.* We did this by listening to our customers and spending years figuring out the correct solution to their issues.

With Kprime we have created a new standard for what GET should do for your business.

Applications

Construction **Trenching**
Mining **Utility**
Quarry

Machine types

Excavators
Wheel loaders



Increased safety features. Increased productivity. Increased reliability.

Kprime tooth system



Safety enhancements

- Intuitive locking system
- Pry slots on tooth and wear cap
- for easier removal of worn parts
- Low torque pin for easy tooth changes
- Weights marked on all parts

Productivity

- 10% - 15% increased usable wear material
- Improved penetration by up to 15%
- Wear indicators on wear cap and fastener
- Rotatable tooth for extended life
- Wear material added to adapter legs
- for longer wear life
- Designed to stay sharp for the life of the tooth

Reliability

- 10% stronger design reduces breakage
- Improved pin design prevents unlocking after extended use
- Optimized design reduces wear on adapters
- Improved stability through tighter fit design of tooth to adapter

Tooling

- Standard single hex socket required for locking/unlocking retaining pins

Safety enhancements

Safety enhancements

- Push out ramp on tooth to help dislodge the fastener when unlocking
- Audible “Clack” sound indicating when locked
- Pin designed for multiple tooth changes
- Wear indicator on hex head of pin
- Metric socket for locking and unlocking
- Simple 1/4 rotation to lock/unlock

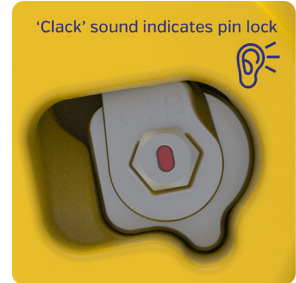
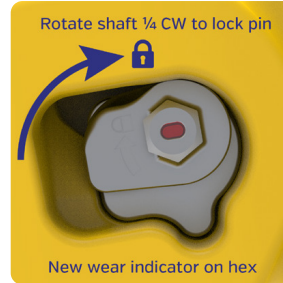

| Tooth size | Socket needed |
|------------|---------------|
| 004-005 | 8MM |
| 010-015 | 10MM |
| 020-030 | 12MM |
| 040-050 | 14MM |
| 070-085 | 16MM |
| 120-400 | 19MM |



New pry out features make removal of wear cap, tooth and pin easy

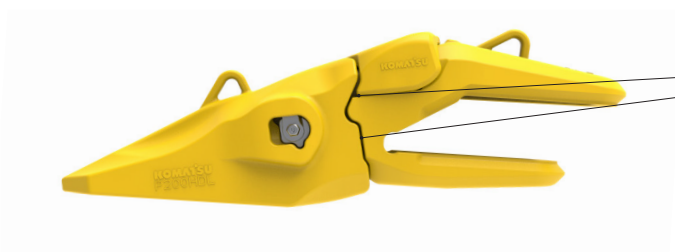
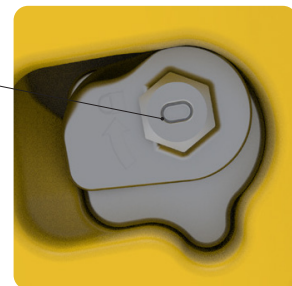

Interlocking parts assist when replacing wear cap and teeth

Weight Indicators are cast into each part in Kilograms. This allows for easier handling and proper tool selection during assembly

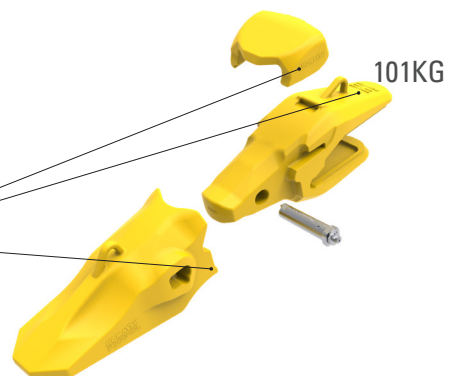

Reliability



10% increased strength and less stress tooth design over XS tooth system



Redesigned wear cap has interior stabilizing leg up to 50% stronger than XS tooth system

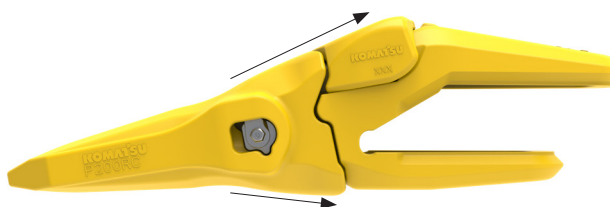
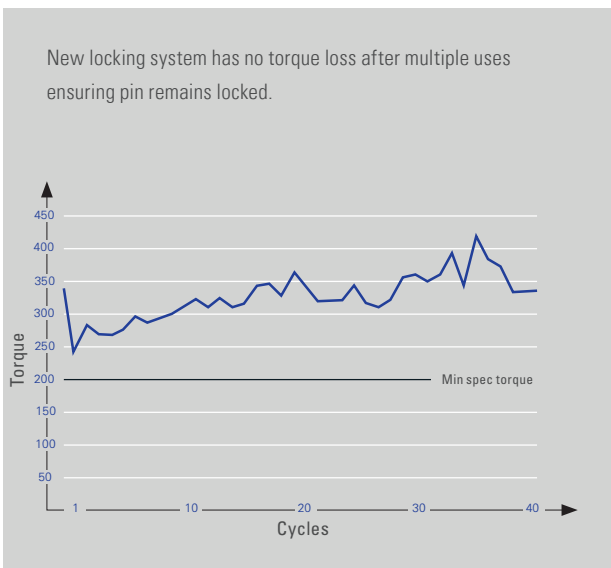
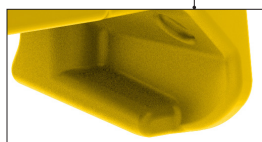

New tooth and wear cap redesigned to deflect material flow away

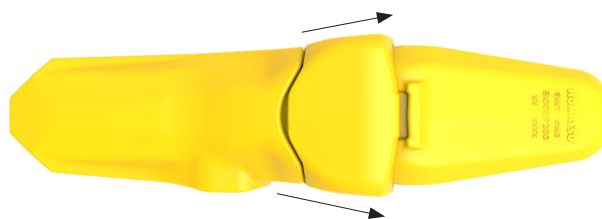

from the adapter improving the overall assembly wear life

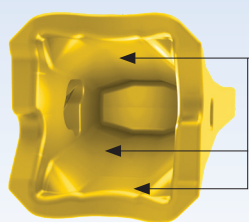

Multi and elevated fit surfaces provide better tooth fit

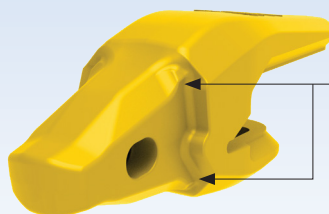

Twist control reduces load on fastener

Productivity

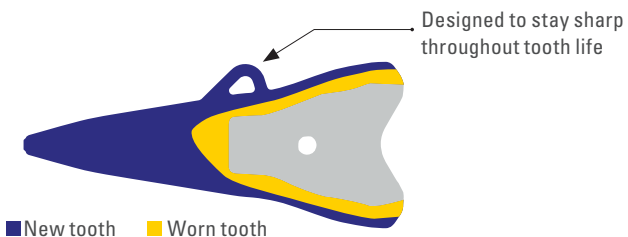
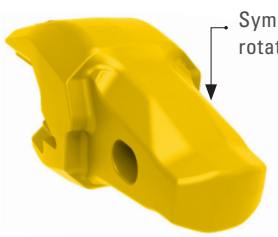
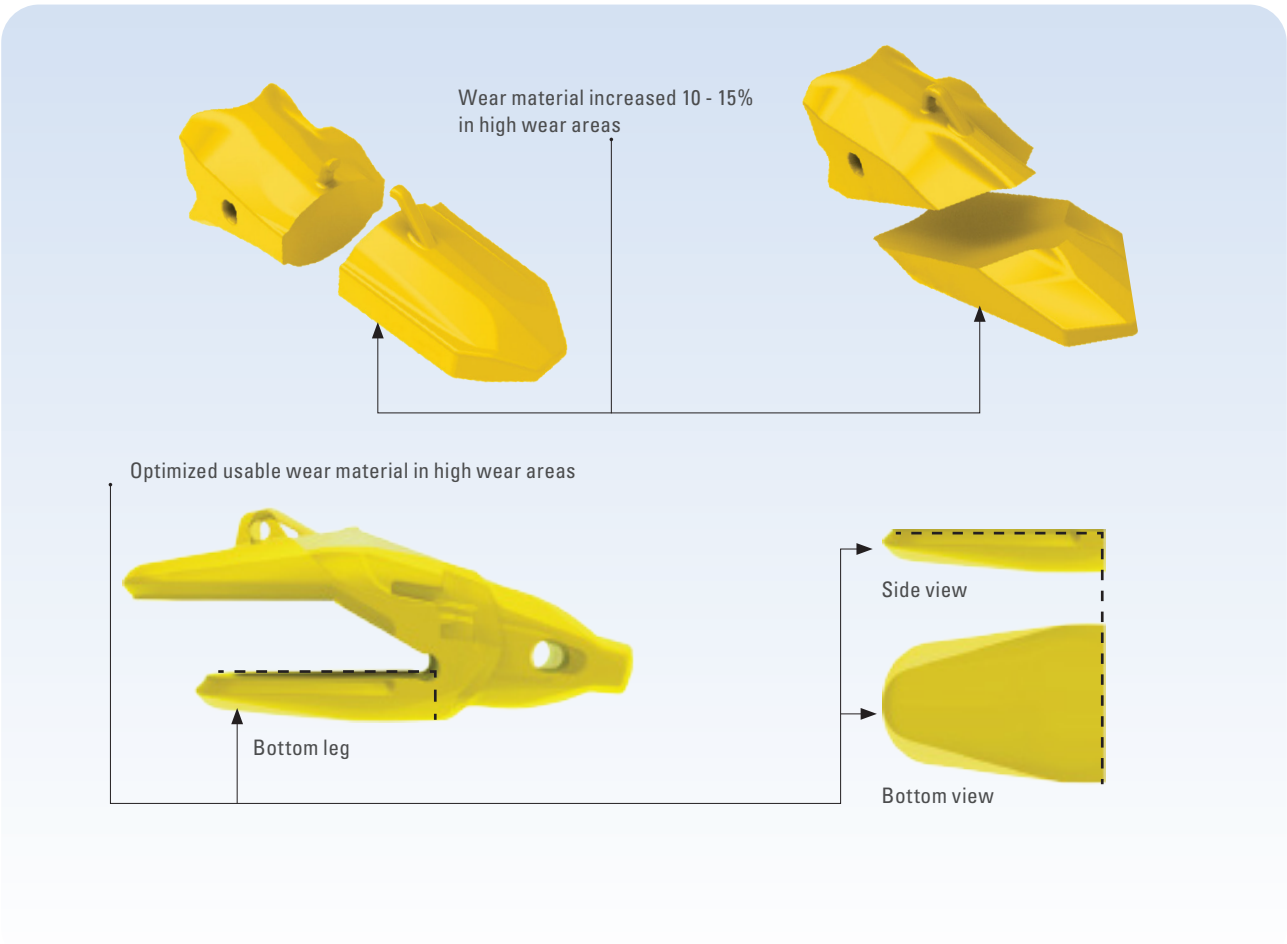
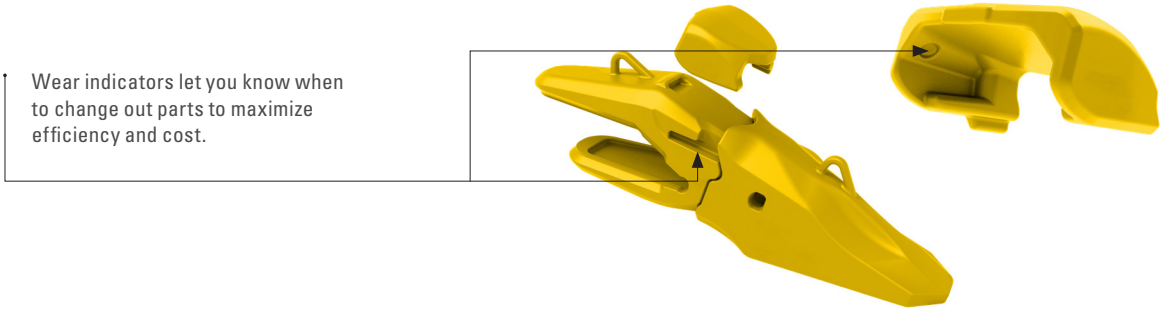

Excavator teeth

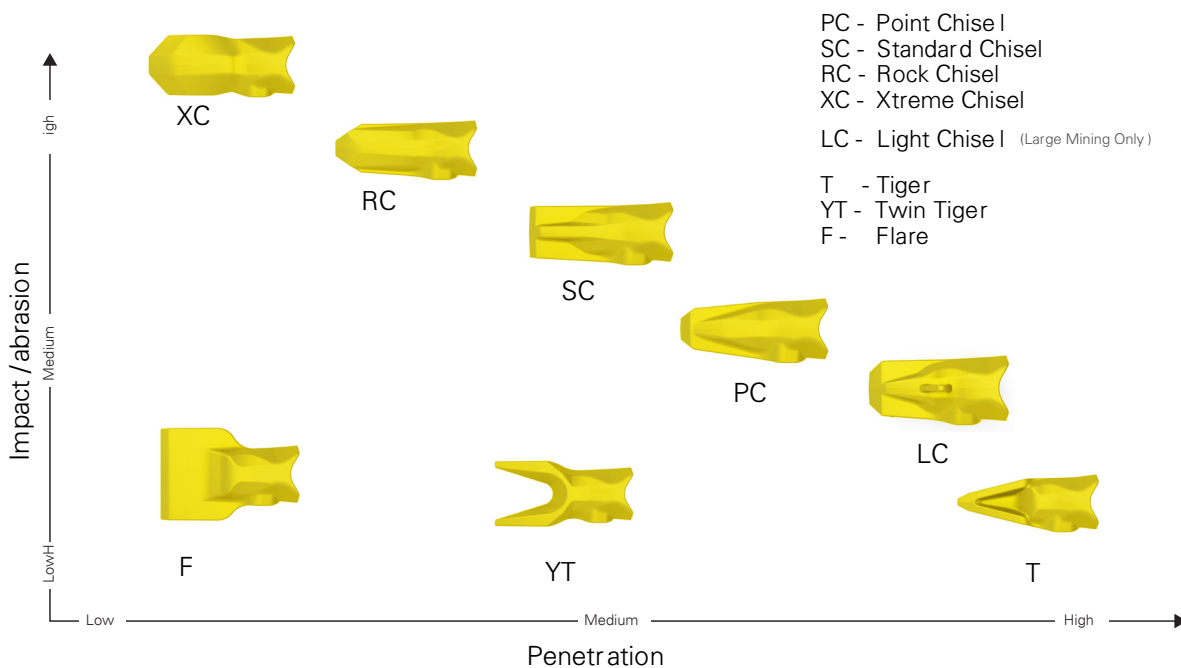

Excavator adapters



1 3/4 half leg (Mining)
1 1/2 half leg (Construction)



Straddle leg



Weld-on nose



Cast corner



Flush mount



Notch



Note: Not all adapter/tooth styles are available for all series.

Excavator tooth sizes available

| Series | Machine Class | Part Number | | | | | | | |
|--------|---------------|-------------|--------|--------|--------|--------|--------|--------|-------|
| | | T | YT | PC | LC | SC | RC | XC | F |
| P004 | 004 | | | | | | P004RC | | |
| P005 | 005 | | | | | | P005RC | | |
| P010 | 010 | | | | | | P010RC | | |
| P015 | 015 | P015T | P015YT | P015PC | | P015SC | P015RC | | P015F |
| P020 | 020 | P020T | P020YT | P020PC | | P020SC | P020RC | | P020F |
| P025 | 025 | P025T | P025YT | P025PC | | P025SC | P025RC | | P025F |
| P030 | 030 | P030T | P030YT | P030PC | | P030SC | P030RC | | P030F |
| P040 | 040 | P040T | P040YT | P040PC | | P040SC | P040RC | P040XC | P040F |
| P050 | 050 | P050T | P050YT | P050PC | | P050SC | P050RC | P050XC | P050F |
| P070 | 070 | P070T | P070YT | P070PC | | P070SC | P070RC | P070XC | P070F |
| P085 | 085 | P085T | P085YT | | | P085SC | P085RC | P085XC | |
| P120 | 120 | P120T | P120YT | P120PC | | P120SC | P120RC | | |
| P200 | 200 | P200T | | P200PC | P200LC | | P200RC | | |
| P300 | 300 | P300T | | P300PC | P300LC | | P300RC | P300XC | |
| P400 | 400 | P400T | | P400PC | P400LC | | P400RC | | |

Adapter part # selector

| | | | | |
|----------|----------|----------|----------|----------|
| A | B | C | D | E |
| 5 | 120 | W | P200 | R |

Choose the number from each of the tables below to determine the proper part #.

| A | Adapter type | B | Lip thickness mm | C | Wear cap use | C | Series | E | Series |
|----|-----------------------------------|-----|------------------|---|---------------|---|--------|----|--------------|
| 1 | Center & RH/LH bevel 1 ½ leg | 25 | | W | with wear cap | | P004 | R | Right |
| 2 | Center flush | 30 | | | no wear cap | | P005 | L | Left |
| 3 | Corner notched RH/LH | 40 | | | | | P010 | CR | Corner right |
| 4 | Center bottom leg | 45 | | | | | P015 | | |
| 5 | Center and RH/LH bevel 1 ¾ leg | 50 | | | | | P020 | CL | Corner left |
| 6 | Straddle bevel | 75 | | | | | P025 | | |
| 7 | Center square | 90 | | | | | P030 | | |
| 8 | Center bolt-on / mechanical | 100 | | | | | P040 | | |
| 9 | Straddle square | 120 | | | | | P050 | | |
| 10 | Straddle flush | 140 | | | | | P070 | | |
| 11 | Corner Closed | | | | | | P085 | | |
| 12 | Corner bolt-on RH/LH / mechanical | | | | | | P120 | | |
| 13 | Corner cast T | | | | | | P200 | | |
| 14 | Corner cast RH/ LH | | | | | | P300 | | |
| | | | | | | | P400 | | |

Loader teeth

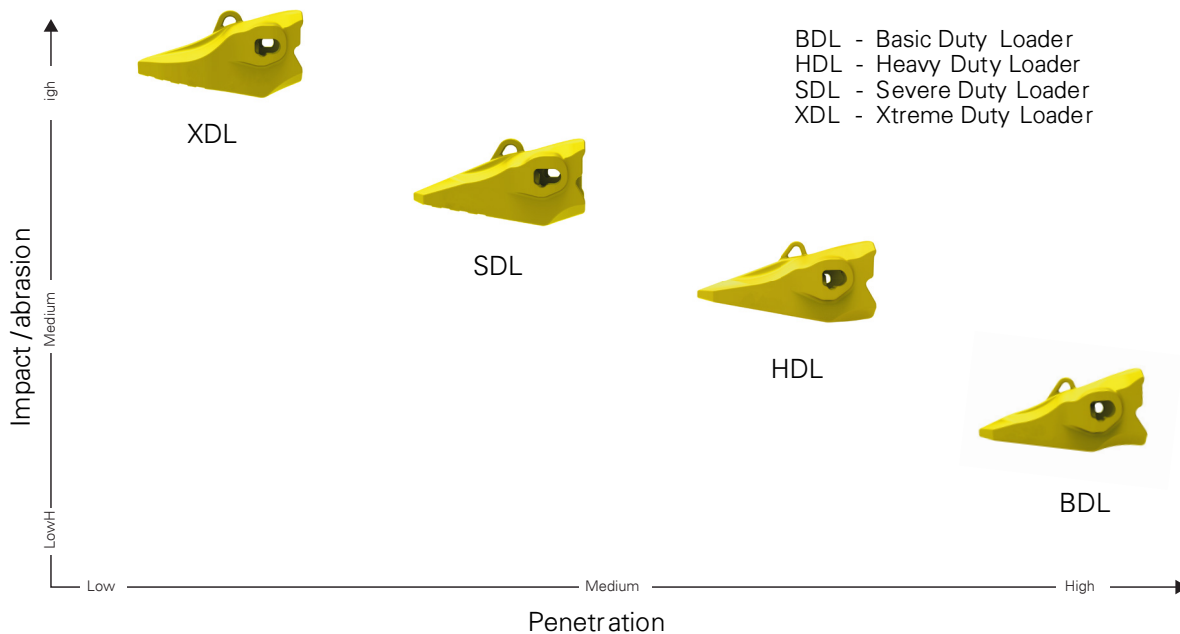

Loader adapters

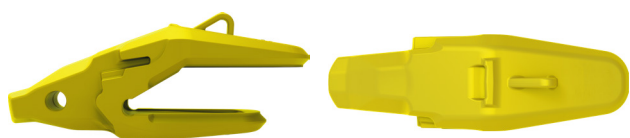

1 3/4 half leg (Mining)
1 1/2 half leg (Construction)

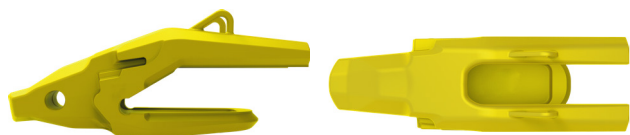

Straddle leg

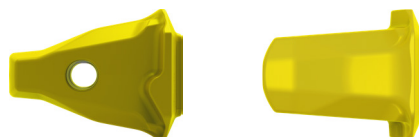

Weld-on nose

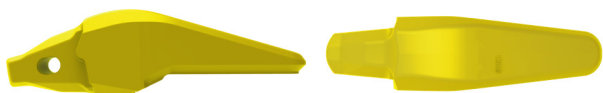

Flush mount

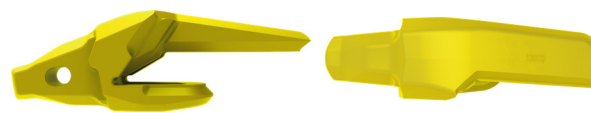

Notch

Note: Not all adapter/tooth styles are available for all series.

Loader tooth sizes available

| Series | Machine Class | Part Number | | | |
|--------|---------------|-------------|---------|---------|---------|
| | | BDL | HDL | SDL | XDL |
| P010 | 010 | | P010HDL | | |
| P015 | 015 | P015BDL | P015HDL | P015SDL | |
| P020 | 020 | P020BDL | P020HDL | P020SDL | |
| P025 | 025 | P025BDL | P025HDL | P025SDL | |
| P030 | 030 | P030BDL | P030HDL | P030SDL | |
| P040 | 040 | | P040HDL | P040SDL | P040XDL |
| P050 | 050 | | P050HDL | P050SDL | P050XDL |
| P070 | 070 | | P070HDL | P070SDL | P070XDL |
| P085 | 085 | P085BDL | P085HDL | P085SDL | P085XDL |
| P120 | 120 | | P120HDL | P120SDL | P120XDL |
| P200 | 200 | P200BDL | P200HDL | P200SDL | P200XDL |

Adapter part # selector

| | | | | |
|----------|----------|----------|----------|----------|
| A | B | C | D | E |
| 5 | 120 | W | P200 | R |

Choose the number from each of the tables below to determine the proper part #.

| A | Adapter type | B | Lip thickness mm | C | Wear cap use | C | Series | E | Series |
|----|-----------------------------------|-----|------------------|---|---------------|---|--------|----|--------------|
| 1 | Center & RH/LH bevel 1 ½ leg | 25 | | W | with wear cap | | P004 | R | Right |
| 2 | Center flush | 30 | | | no wear cap | | P005 | L | Left |
| 3 | Corner notched RH/LH | 40 | | | | | P010 | CR | Corner right |
| 4 | Center bottom leg | 45 | | | | | P015 | | |
| 5 | Center and RH/LH bevel 1 ¾ leg | 50 | | | | | P020 | CL | Corner left |
| 6 | Straddle bevel | 75 | | | | | P025 | | |
| 7 | Center square | 90 | | | | | P030 | | |
| 8 | Center bolt-on / mechanical | 100 | | | | | P040 | | |
| 9 | Straddle square | 120 | | | | | P050 | | |
| 10 | Straddle flush | 140 | | | | | P070 | | |
| 11 | Corner Closed | | | | | | P085 | | |
| 12 | Corner bolt-on RH/LH / mechanical | | | | | | P120 | | |
| 13 | Corner cast T | | | | | | P200 | | |
| 14 | Corner cast RH/ LH | | | | | | P300 | | |
| | | | | | | | P400 | | |

**Increased safety features.
Increased productivity.
Increased reliability.**

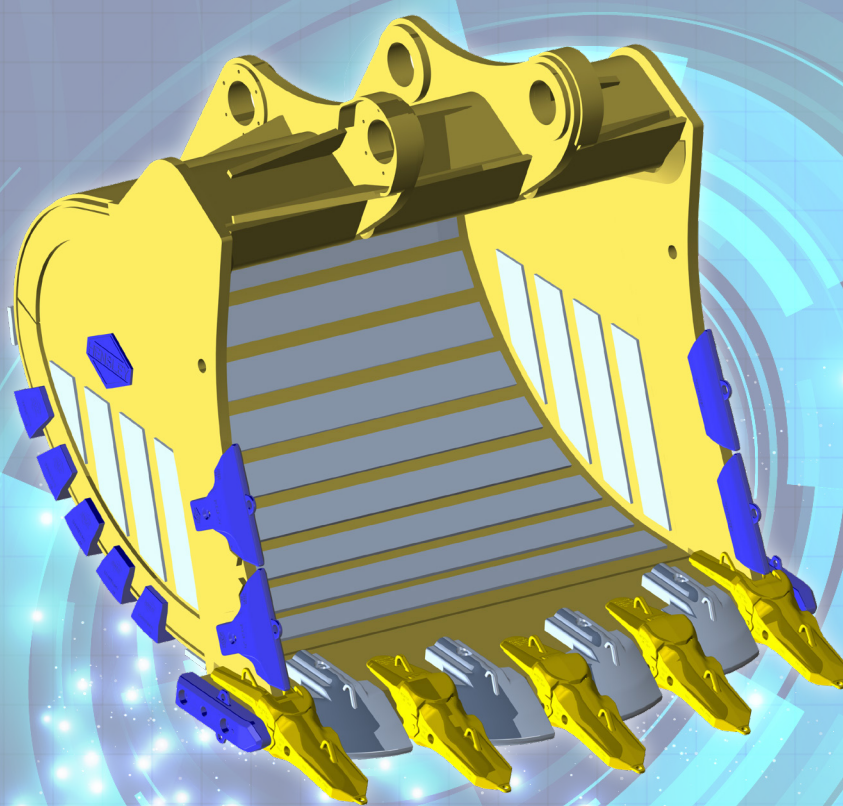

Komatsu Australia:

1300 566 287 | www.komatsu.com.au

Parts portal (AU) – myKomatsu:

1300 199 054 | my.komatsu.com.au | online@komatsu.com.au

Komatsu New Zealand:

0800 566 2878 | www.komatsu.co.nz

Parts portal (NZ) – myKomatsu:

0800 433 116 | my.komatsu.co.nz | online@komatsu.co.nz

New Caledonia:

+687 43 53 06

Hensley Industries, INC:

USA/Canada – (888) 406-6262 | International – +1 (972) 406-6262 | www.HENSLEYIND.com

Your Komatsu partner:

Product designs, specifications and/or data in this document are provided for informational purposes only and are not warranties of any kind. Product designs and/or specifications may be changed at any time without notice. The only warranties that apply to sales of products and services are Komatsu's standard written warranties, which will be furnished upon request.

Komatsu and other trademarks and service marks used herein are the property of Komatsu Ltd., Komatsu Australia Pty Ltd., Komatsu America Corp., Komatsu Mining Corp., or one of their affiliates, or the respective owners or licensees.

KOMATSU

